

# KANAWHA WESTERN LANDFILL

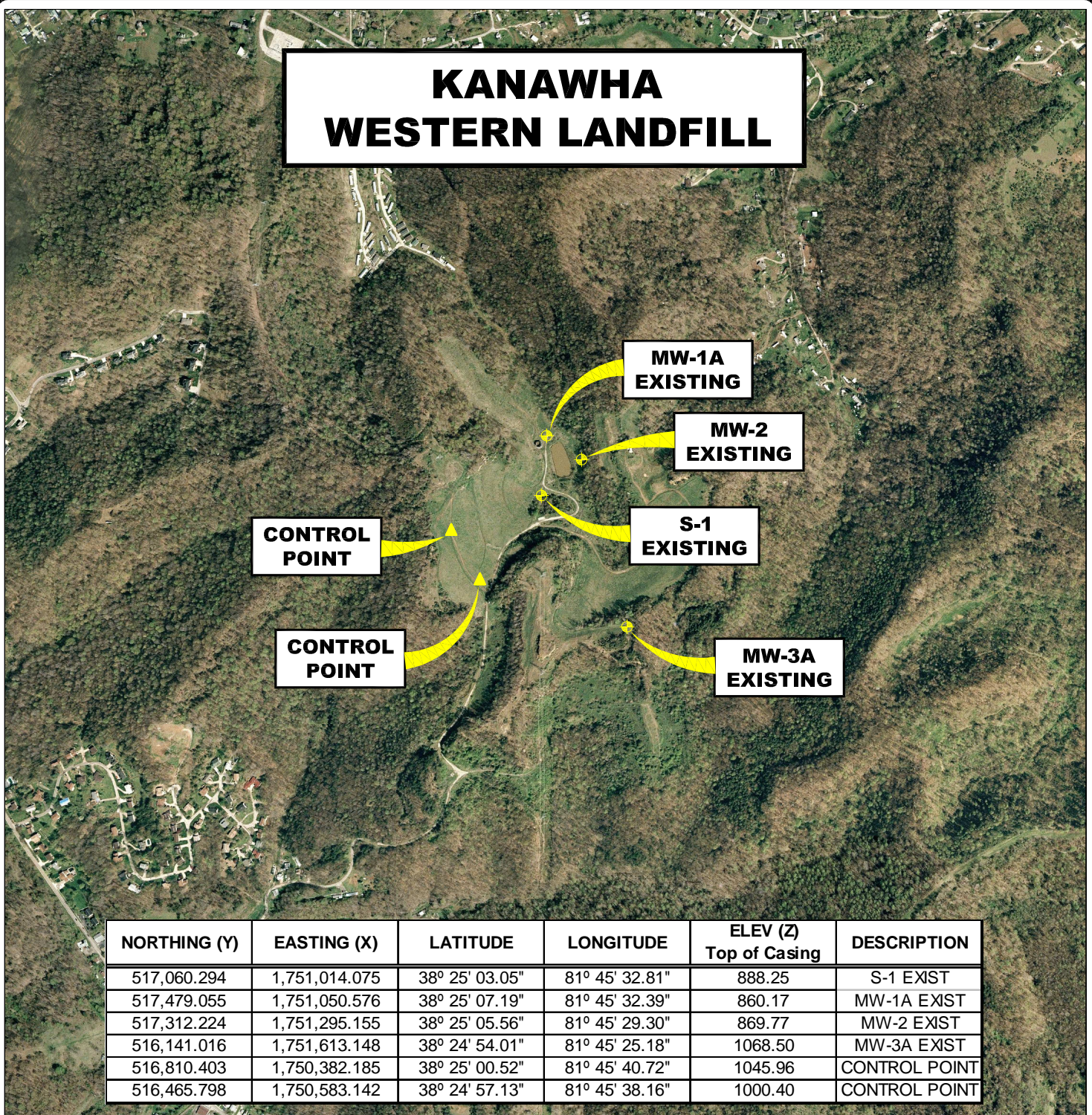

NORTHING (Y)	EASTING (X)	LATITUDE	LONGITUDE	ELEV (Z) Top of Casing	DESCRIPTION
517,060.294	1,751,014.075	38° 25' 03.05"	81° 45' 32.81"	888.25	S-1 EXIST
517,479.055	1,751,050.576	38° 25' 07.19"	81° 45' 32.39"	860.17	MW-1A EXIST
517,312.224	1,751,295.155	38° 25' 05.56"	81° 45' 29.30"	869.77	MW-2 EXIST
516,141.016	1,751,613.148	38° 24' 54.01"	81° 45' 25.18"	1068.50	MW-3A EXIST
516,810.403	1,750,382.185	38° 25' 00.52"	81° 45' 40.72"	1045.96	CONTROL POINT
516,465.798	1,750,583.142	38° 24' 57.13"	81° 45' 38.16"	1000.40	CONTROL POINT

## AERIAL MAP MONITORING WELL LOCATIONS

CROSS LANES, KANAWHA COUNTY, WEST VIRGINIA

0'                      1,000'                      2,000'                      3,000'



SCALE: 1 INCH = 1,000 FEET



**Stantec Consulting Services Inc.**

1 Moore Avenue  
Buckhannon WV 26201  
Tel. 304.472.7140  
Fax. 304.472.6239  
www.stantec.com

PROJECT NO.	173611045
SURVEYED BY:	WAG
DRAWN BY:	JHL
CHECKED BY:	DEM
APPROVED BY:	JHL
DATE:	SEPTEMBER 25, 2009

**NOTE:**  
HORIZONTAL DATUM :  
WEST VIRGINIA STATE PLANE COORDINATES  
NAD 83 SOUTH ZONE (CORS 96).  
  
VERTICAL DATUM : NAVD 88 GEOID 03 (CONUS)  
  
COORDINATE UNITS : US SURVEY FOOT  
DISTANCE UNITS : US SURVEY FOOT  
HEIGHT UNITS : US SURVEY FOOT

SHT. NO.	2
TOTAL	2