

GRANT COUNTY PETERSBURG LANDFILL

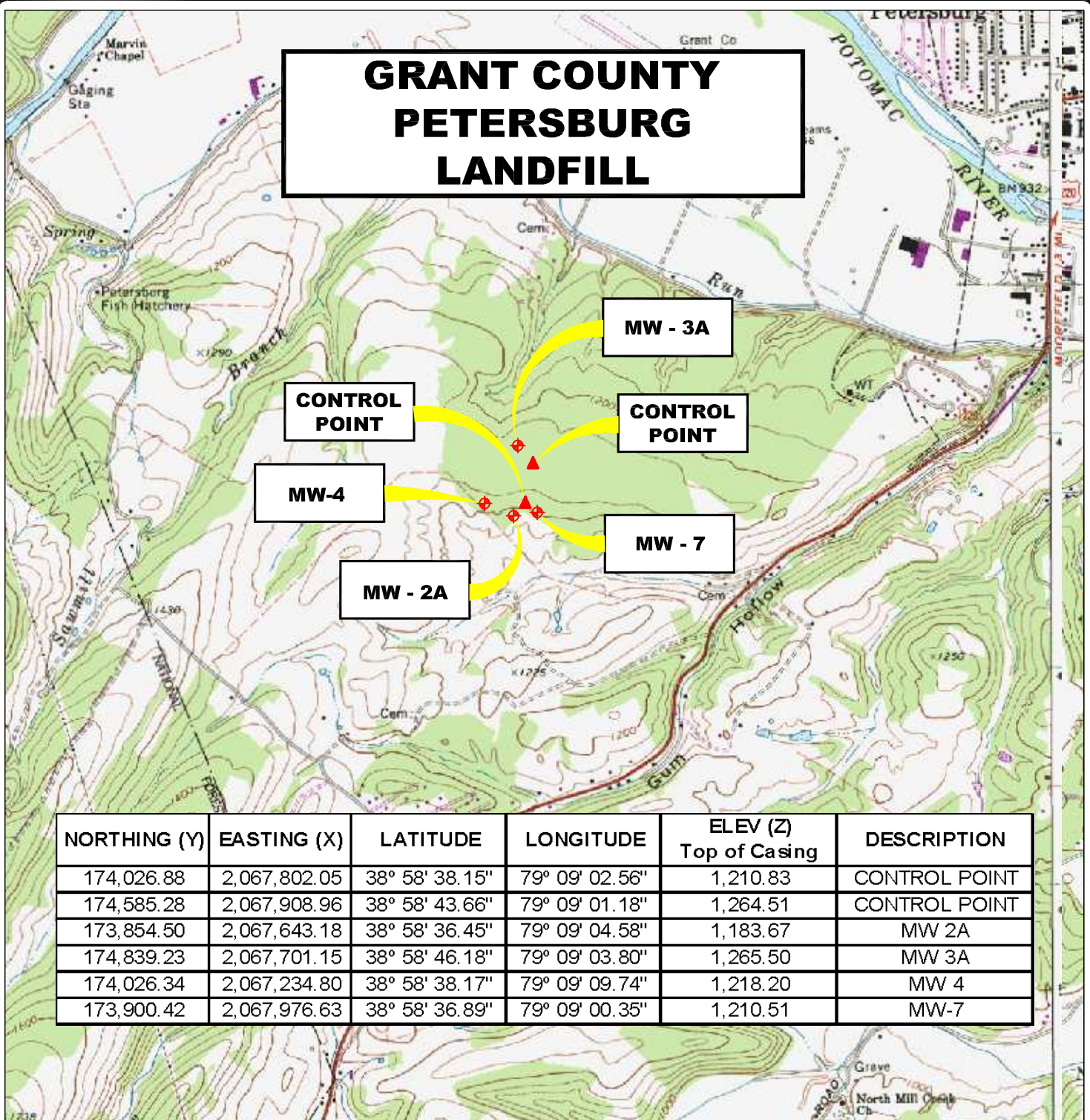

NORTHING (Y)	EASTING (X)	LATITUDE	LONGITUDE	ELEV (Z) Top of Casing	DESCRIPTION
174,026.88	2,067,802.05	38° 58' 38.15"	79° 09' 02.56"	1,210.83	CONTROL POINT
174,585.28	2,067,908.96	38° 58' 43.66"	79° 09' 01.18"	1,264.51	CONTROL POINT
173,854.50	2,067,643.18	38° 58' 36.45"	79° 09' 04.58"	1,183.67	MW 2A
174,839.23	2,067,701.15	38° 58' 46.18"	79° 09' 03.80"	1,265.50	MW 3A
174,026.34	2,067,234.80	38° 58' 38.17"	79° 09' 09.74"	1,218.20	MW 4
173,900.42	2,067,976.63	38° 58' 36.89"	79° 09' 00.35"	1,210.51	MW-7

LOCATION MAP

PETERSBURG WEST 7.5' U.S.G.S. QUADRANGLE

0' 2,000' 4,000' 6,000'



SCALE: 1 INCH = 2,000 FEET



Stantec Consulting Services Inc.

1 Moore Avenue
Buckhannon WV 26201
Tel. 304.472.7140
Fax. 304.472.6239
www.stantec.com

PROJECT NO.	173611044
SURVEYED BY:	JB
DRAWN BY:	JMS
CHECKED BY:	DEM
APPROVED BY:	JHL
DATE:	MARCH 2010

NOTE:
HORIZONTAL DATUM :
WEST VIRGINIA STATE PLANE COORDINATES
NAD 83 NORTH ZONE (CORS 96).

VERTICAL DATUM : NAVD 88 GEOID 09 (CONUS)

COORDINATE UNITS : US SURVEY FOOT
DISTANCE UNITS : US SURVEY FOOT
HEIGHT UNITS : US SURVEY FOOT

SHT. NO.
1
TOTAL
2