

PINECREEK OMAR LANDFILL

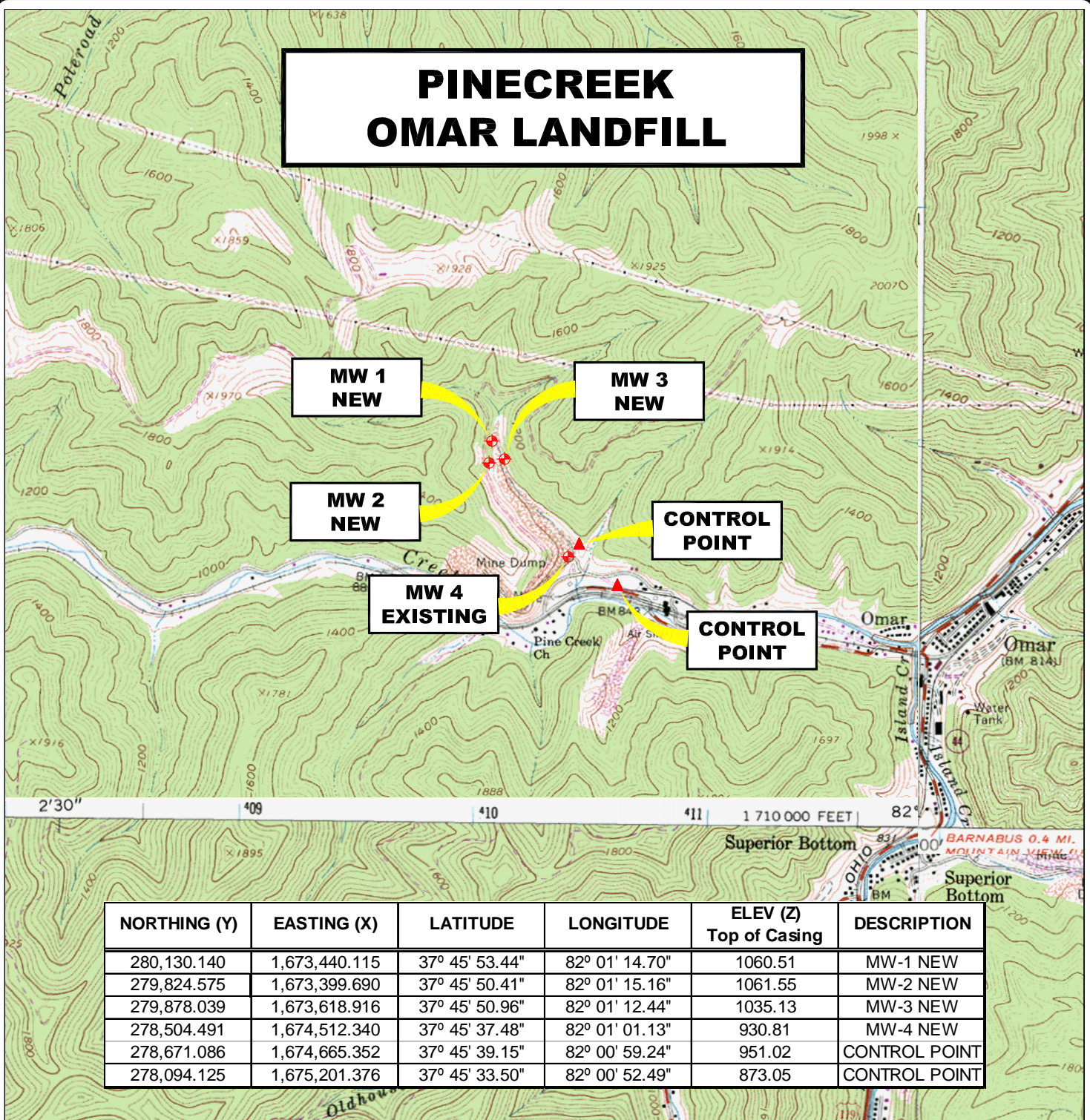

| NORTHING (Y) | EASTING (X) | LATITUDE | LONGITUDE | ELEV (Z) Top of Casing | DESCRIPTION |
|--------------|---------------|----------------|----------------|---------------------------|---------------|
| 280,130.140 | 1,673,440.115 | 37° 45' 53.44" | 82° 01' 14.70" | 1060.51 | MW-1 NEW |
| 279,824.575 | 1,673,399.690 | 37° 45' 50.41" | 82° 01' 15.16" | 1061.55 | MW-2 NEW |
| 279,878.039 | 1,673,618.916 | 37° 45' 50.96" | 82° 01' 12.44" | 1035.13 | MW-3 NEW |
| 278,504.491 | 1,674,512.340 | 37° 45' 37.48" | 82° 01' 01.13" | 930.81 | MW-4 NEW |
| 278,671.086 | 1,674,665.352 | 37° 45' 39.15" | 82° 00' 59.24" | 951.02 | CONTROL POINT |
| 278,094.125 | 1,675,201.376 | 37° 45' 33.50" | 82° 00' 52.49" | 873.05 | CONTROL POINT |

LOCATION MAP

HOLDEN 7.5' U.S.G.S. QUADRANGLE

0' 2,000' 4,000' 6,000'



SCALE: 1 INCH = 2,000 FEET



Stantec

Stantec Consulting Services Inc.

1 Moore Avenue
Buckhannon WV 26201
Tel. 304.472.7140
Fax. 304.472.6239
www.stantec.com

PROJECT NO. 173611045
SURVEYED BY: WAG
DRAWN BY: JHL
CHECKED BY: DEM
APPROVED BY: JHL
DATE: SEPTEMBER 23, 2009

NOTE:
HORIZONTAL DATUM :
WEST VIRGINIA STATE PLANE COORDINATES
NAD 83 SOUTH ZONE (CORS 96).

VERTICAL DATUM : NAVD 88 GEOID 03 (CONUS)

COORDINATE UNITS : US SURVEY FOOT
DISTANCE UNITS : US SURVEY FOOT
HEIGHT UNITS : US SURVEY FOOT

SHT. NO.
1
TOTAL
2