

# WYOMING COUNTY LANDFILL

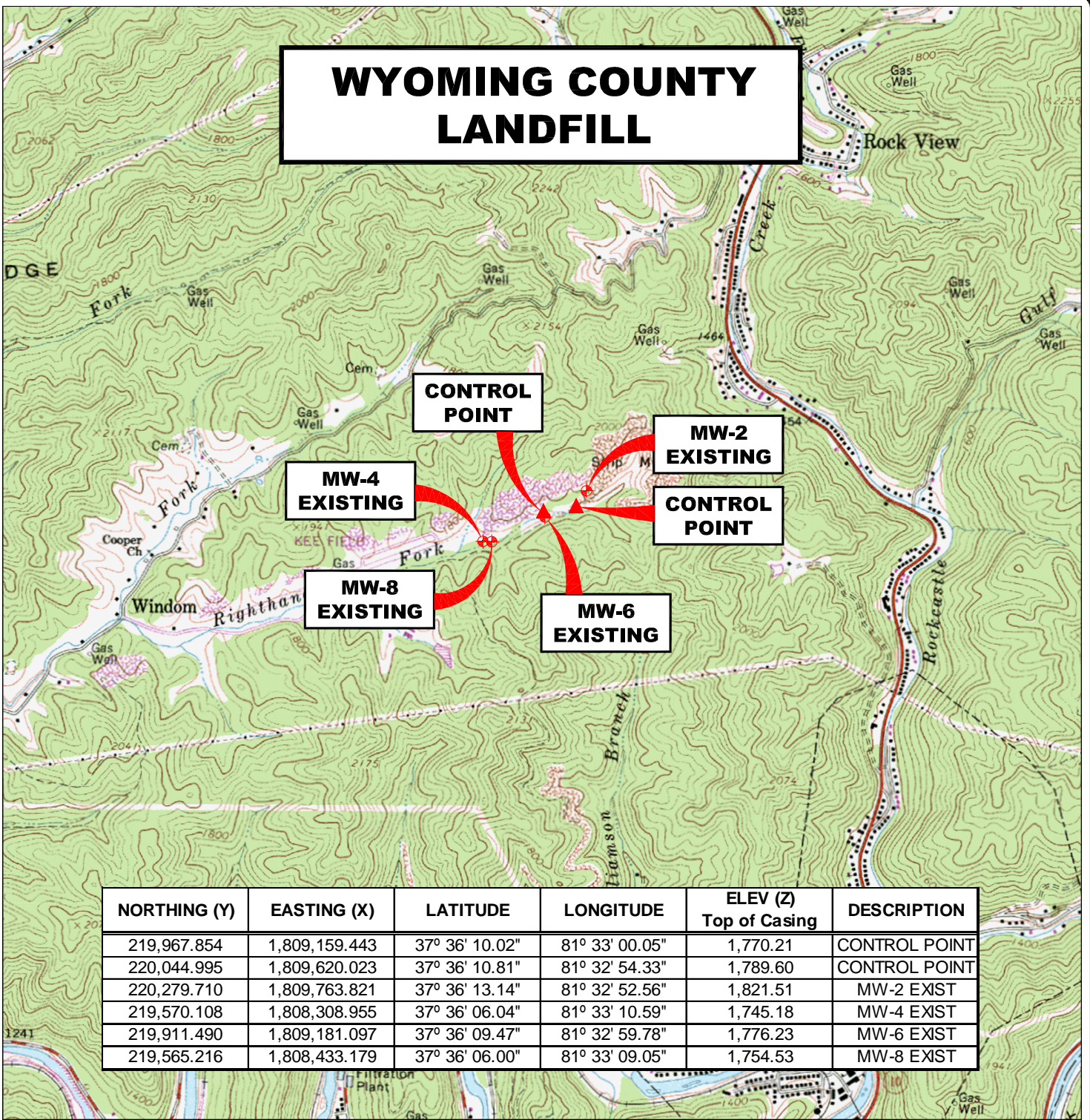

NORTHING (Y)	EASTING (X)	LATITUDE	LONGITUDE	ELEV (Z) Top of Casing	DESCRIPTION
219,967.854	1,809,159.443	37° 36' 10.02"	81° 33' 00.05"	1,770.21	CONTROL POINT
220,044.995	1,809,620.023	37° 36' 10.81"	81° 32' 54.33"	1,789.60	CONTROL POINT
220,279.710	1,809,763.821	37° 36' 13.14"	81° 32' 52.56"	1,821.51	MW-2 EXIST
219,570.108	1,808,308.955	37° 36' 06.04"	81° 33' 10.59"	1,745.18	MW-4 EXIST
219,911.490	1,809,181.097	37° 36' 09.47"	81° 32' 59.78"	1,776.23	MW-6 EXIST
219,565.216	1,808,433.179	37° 36' 06.00"	81° 33' 09.05"	1,754.53	MW-8 EXIST

## LOCATION MAP

PINEVILLE 7.5' U.S.G.S. QUADRANGLE

0' 2,000' 4,000' 6,000'



SCALE: 1 INCH = 2,000 FEET



### Stantec Consulting Services Inc.

1 Moore Avenue  
Buckhannon WV 26201  
Tel. 304.472.7140  
Fax. 304.472.6239  
www.stantec.com

PROJECT NO. 173611045  
SURVEYED BY: WAG  
DRAWN BY: JHL  
CHECKED BY: DEM  
APPROVED BY: JHL  
DATE: MARCH 11, 2010

NOTE:  
HORIZONTAL DATUM :  
WEST VIRGINIA STATE PLANE GRID COORDINATES  
NAD 83 SOUTH ZONE (CORS 96).

VERTICAL DATUM : NAVD 88 GEOID 09 (CONUS)

COORDINATE UNITS : US SURVEY FOOT  
DISTANCE UNITS : US SURVEY FOOT  
HEIGHT UNITS : US SURVEY FOOT

SHT. NO.  
1  
TOTAL  
2