



---

west virginia department of environmental protection

---

Office of Oil and Gas  
601 57<sup>th</sup> Street, S.E.  
Charleston, WV 25304  
(304) 926-0450  
fax: (304) 926-0452

Austin Caperton, Cabinet Secretary  
[www.dep.wv.gov](http://www.dep.wv.gov)

Monday, March 19, 2018  
PERMIT MODIFICATION APPROVAL  
Horizontal 6A / Horizontal 6A Well - 1

SWN PRODUCTION COMPANY, LLC  
POST OFFICE BOX 12359

SPRING, TX 773914954

Re: Permit Modification Approval for B & W EDGE MSH 205H  
47-051-01843-00-00

Modified Casing 6A1, Schematic

SWN PRODUCTION COMPANY, LLC

The Office of Oil and Gas has reviewed the attached permit modification for the above referenced permit. The attached modification has been approved and well work may begin. Please be reminded that the oil and gas inspector is to be notified twenty-four (24) hours before permitted well work is commenced.

If there are any questions, please feel free to contact me at (304) 926- 0450.

A blue ink signature of James A. Martin, written in a cursive style.

James A. Martin  
Chief

Operator's Well Number: B & W EDGE MSH 205H  
Farm Name: EDGE, WILLIAM JR. & BARBARA  
U.S. WELL NUMBER: 47-051-01843-00-00  
Horizontal 6A Horizontal 6A Well - 1  
Date Modification Issued: March 19, 2018

Promoting a healthy environment.

WW-6B  
(10/14)

4705101982 *mab*

API NO. 47- 69 -  
OPERATOR WELL NO. B W Edge MSH 205H  
Well Pad Name: B W Edge MSH Pad

STATE OF WEST VIRGINIA  
DEPARTMENT OF ENVIRONMENTAL PROTECTION, OFFICE OF OIL AND GAS  
WELL WORK PERMIT APPLICATION

1) Well Operator: SWN Production Co., LLC 494512924 51-Marshall 6- Sand 647- Wheeling  
Operator ID County District Quadrangle

2) Operator's Well Number: B W Edge MSH 205H Well Pad Name: B W Edge MSH Pad

3) Farm Name/Surface Owner: William F. Jr., & Barbara Edge Public Road Access: Big Wheeling Creek Road

4) Elevation, current ground: 1254' Elevation, proposed post-construction: 1254'

5) Well Type (a) Gas  Oil  Underground Storage   
Other

(b) If Gas Shallow  Deep   
Horizontal

6) Existing Pad: Yes or No yes

7) Proposed Target Formation(s), Depth(s), Anticipated Thickness and Associated Pressure(s):  
Target Formation- Marcellus, Target Top TVD- 6370', Target Base TVD- 6405', Anticipated Thickness- 35', Associated Pressure- 4146

8) Proposed Total Vertical Depth: 6377'

9) Formation at Total Vertical Depth: Marcellus

10) Proposed Total Measured Depth: 15,528'

11) Proposed Horizontal Leg Length: 8,129'

12) Approximate Fresh Water Strata Depths: 615'

13) Method to Determine Fresh Water Depths: No wells on pad. Closest water well discovered from baseline data. Former approximately 2000' down/ft and in the direction of surface drainage.

14) Approximate Saltwater Depths: 930' No wells on pad. Michael Southworth SPH WR-35 depth is 950' and shifted is 930' TVD. Open hole logs for purpose of salinity analysis necessary.

15) Approximate Coal Seam Depths: 748'

16) Approximate Depth to Possible Void (coal mine, karst, other): None that we are aware of.

17) Does Proposed well location contain coal seams directly overlying or adjacent to an active mine? Yes  No

(a) If Yes, provide Mine Info: Name: \_\_\_\_\_  
Depth: 742'  
Seam: Pittsburgh Seam  
Owner: Shoemaker

RECEIVED  
Office of Oil and Gas  
MAR 8 2018  
RECEIVED  
Office of Oil and Gas  
JAN 9 2018  
WV Department of  
Environmental Protection



WW-6B  
(10/14)

API NO. 47- 69 -  
OPERATOR WELL NO. B W Edge MSH 205H  
Well Pad Name: B W Edge MSH Pad

18)

**CASING AND TUBING PROGRAM**

TYPE	Size (in)	New or Used	Grade	Weight per ft. (lb/ft)	FOOTAGE: For Drilling (ft)	INTERVALS: Left in Well (ft)	CEMENT: Fill-up (Cu. Ft.)/CTS
Conductor	20"	New	H-40	94#	100'	100'	CTS
Fresh Water	13 3/8"	New	H-40	48.0#	800'	800'	739 sx/CTS
Coal	9 5/8"	New	J-55	36#	2000'	2000'	738 sx/CTS
Intermediate	7"	New	J-55	20#	If Needed	If Needed	If Needed/As Needed
Production	5 1/2"	New	HCP-110	20#	15528'	15528'	Lead 9499x 148 2157x1100' inside in <input checked="" type="checkbox"/>
Tubing	2 3/8"	New	P-110	4.7#	Approx. 6377'	Approx. 6377'	
Liners							

*ms*  
10/11/17

TYPE	Size (in)	Wellbore Diameter (in)	Wall Thickness (in)	Burst Pressure (psi)	Max. Associated Surface Pressure (psi)	Cement Type	Cement Yield (cu. ft./k)
Conductor	20"	30"	0.25	2120	81	Class A	1.19/50% Excess
Fresh Water	13 3/8"	17.5"	0.380	2740	633	Class A	1.19/50% Excess
Coal	9 5/8"	12 1/4"	0.395	3950	1768	Class A	1.19/50% Excess
Intermediate	7"	8 3/4"	0.317	4360	3250	Class A	1.20/15% Excess
Production	5 1/2"	8 3/4"	0.361	12360	9500	Class A	1.20/15% Excess
Tubing	2 3/8"	4.778"	0.190	Approx. 8193'	Approx. 8193'		
Liners							

**PACKERS**

Kind:	10K Arrowset AS1-X			
Sizes:	5 1/2"			
Depths Set:				

RECEIVED  
of Oil and Gas

MAR 8 2018

WV Department of  
Environmental Protection

RECEIVED  
Office of Oil and Gas

OCT 16 2017

WV Department of  
Environmental Protection

**Southwestern Energy Company**

**Proposed Drilling Program**

Well: BW EDGE MSH 205  
 Field: PANHANDLE FIELD 1  
 County: MARSHALL  
 SHL: 40.0066 Latitude -80.6275 Longitude  
 BHL: 40.0299 Latitude -80.6359 Longitude  
 KB Elev: 1,290 ft MSL KB: 26 ft AGL

Re-entry Rig: TBD  
 Prospect: PANHANDLE  
 State: WV



GL Elev: 1,254 ft MSL

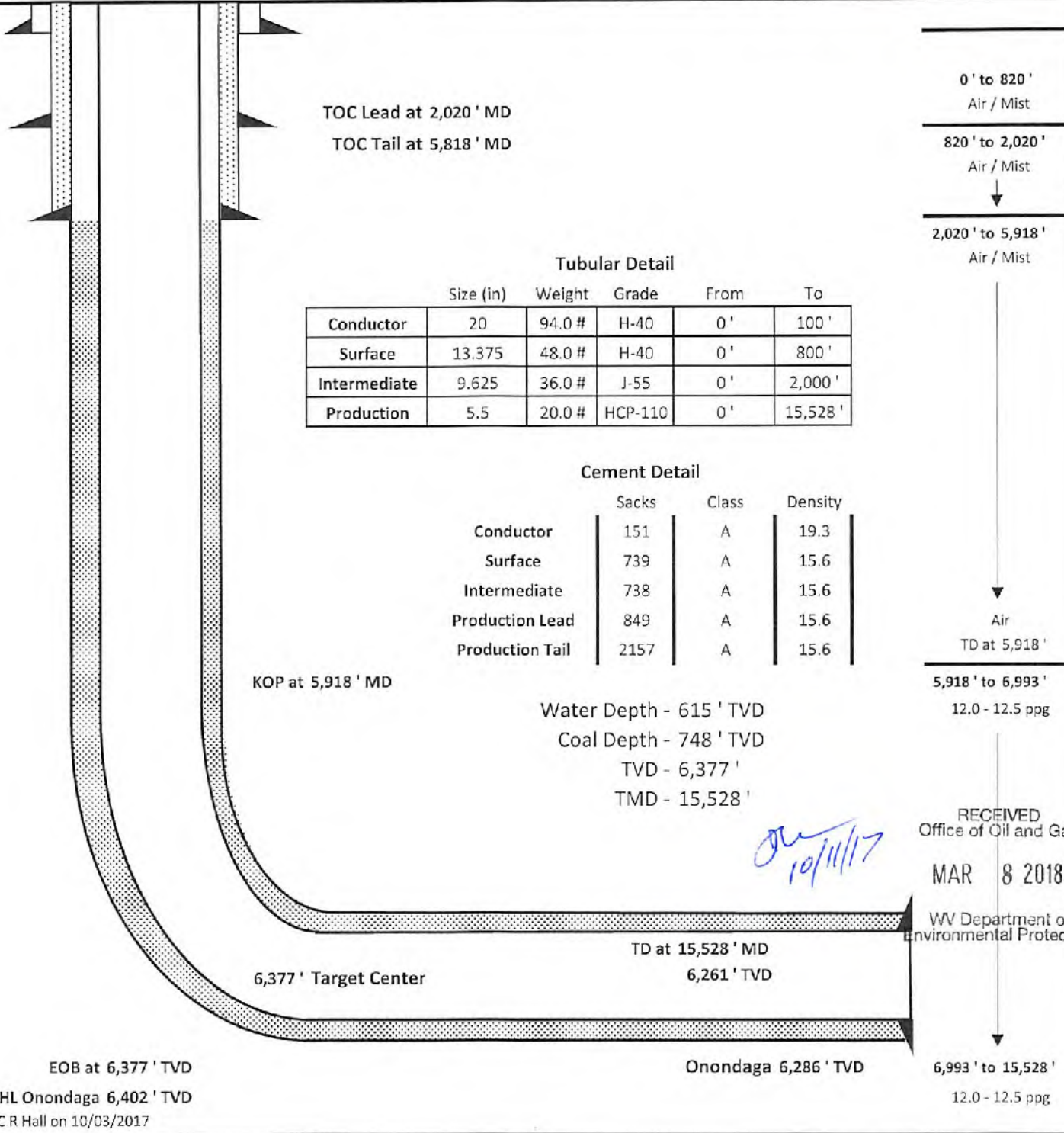

0' to 820' Air / Mist  
 820' to 2,020' Air / Mist  
 ↓  
 2,020' to 5,918' Air / Mist  
 ↓  
 Air  
 TD at 5,918'  
 5,918' to 6,993' 12.0 - 12.5 ppg  
 ↓  
 RECEIVED  
 Office of Oil and Gas  
 MAR 8 2018  
 WV Department of Environmental Protection  
 ↓  
 6,993' to 15,528' 12.0 - 12.5 ppg

*10/11/17*

RECEIVED  
 Office of Oil and Gas  
 OCT 16 2017  
 WV Department of Environmental Protection



WW-6A1  
(5/13)

Operator's Well No. B&W Edge MSH 205H

**INFORMATION SUPPLIED UNDER WEST VIRGINIA CODE  
Chapter 22, Article 6A, Section 5(a)(5)  
IN LIEU OF FILING LEASE(S) AND OTHER CONTINUING CONTRACT(S)**

Under the oath required to make the verification on page 1 of this Notice and Application, I depose and say that I am the person who signed the Notice and Application for the Applicant, and that –

- (1) the tract of land is the same tract described in this Application, partly or wholly depicted in the accompanying plat, and described in the Construction and Reclamation Plan;
- (2) the parties and recordation data (if recorded) for lease(s) or other continuing contract(s) by which the Applicant claims the right to extract, produce or market the oil or gas are as follows:

Lease Name or Number	Grantor, Lessor, etc.	Grantee, Lessee, etc.	Royalty	Book/Page
-------------------------	-----------------------	-----------------------	---------	-----------

SEE EXHIBIT "A"

**Acknowledgement of Possible Permitting/Approval  
In Addition to the Office of Oil and Gas**

The permit applicant for the proposed well work addressed in this application hereby acknowledges the possibility of the need for permits and/or approvals from local, state, or federal entities in addition to the DEP, Office of Oil and Gas, including but not limited to the following:

- WV Division of Water and Waste Management
- WV Division of Natural Resources WV Division of Highways
- U.S. Army Corps of Engineers
- U.S. Fish and Wildlife Service
- County Floodplain Coordinator

RECEIVED  
Office of Oil and Gas

OCT 16 2017

RECEIVED  
WV Department of  
Environmental Protection  
Office of Oil and Gas

The applicant further acknowledges that any Office of Oil and Gas permit in no way overrides, replaces, or nullifies the need for other permits/approvals that may be necessary and further affirms that all needed permits/approvals should be acquired from the appropriate authority before the affected activity is initiated.

MAR 8 2018

WV Department of  
Environmental Protection

Well Operator: SWN Production Company LLC

By: \_\_\_\_\_

Its: \_\_\_\_\_

Tanner Quiring, Staff Landman

EXHIBIT "A"  
Attached to and made a part of the State of West Virginia Oil and Gas Permit Form, WW-6A1, by SWN Production Company, LLC, Operator  
BW Edge MSH 205H  
Marshall and Ohio Counties, West Virginia

JAN 31 2018

WV Department of  
Environmental Protection

#	TMP	SURFACE OWNER	DEEDED ACREAGE	LEASE #	LESSOR	LESSEE	ROYALTY %	DATE
1)	12-9-8	William F. Jr. and Barbara Edge	87.80	733642-000	Josephine Fletcher	NPAR LLC Chevron Chesapeake Appalachia L.L.C. SWN Production Company L.L.C.	20.00%	756/332 30/532 33/110
2)	12-9-8.1	Wheeling Power Company	28.00	733642-000	Josephine Fletcher	NPAR LLC Chevron Chesapeake Appalachia L.L.C. SWN Production Company L.L.C.	20.00%	707/584 756/332 30/532 33/110
3)	12-1-16	Chester A. Giza	53.40	732583-000	Chester A. Giza Tri Energy Holdings L.L.C. NPAR L.L.C. Chevron USA, Inc. Chesapeake Appalachia L.L.C. SWN Production Company L.L.C.	Tri Energy Holdings L.L.C. NPAR L.L.C. Chevron USA, Inc. Chesapeake Appalachia L.L.C. SWN Production Company L.L.C.	18.75%	697/483 24/180 756/332 30/532 33/110
4)	12-1-15	Chester A. Giza	53.10	732583-000	Chester A. Giza Tri Energy Holdings L.L.C. NPAR L.L.C. Chevron USA, Inc. Chesapeake Appalachia L.L.C.	Tri Energy Holdings L.L.C. NPAR L.L.C. Chevron USA, Inc. Chesapeake Appalachia L.L.C. SWN Production Company L.L.C.	18.75%	697/483 24/180 756/332 30/532 33/110
5)	12-1-18	Mark A. Schellhase and Andrea K. Schellhase	93.80	728932-000	Mark A. Schellhase and Andrea K. Schellhase	Chesapeake Appalachia L.L.C.	18.00%	721/468 33/110
6)	12-1-18.5	Mark A. Schellhase and Andrea K. Schellhase	0.90	728932-000	Mark A. Schellhase and Andrea K. Schellhase	Chesapeake Appalachia L.L.C.	18.00%	721/468 33/110
7)	12-01-18.2	Chester L. and Karen S. Smith	0.5	733671-000	Chester L. and Karen S. Smith	Tri Energy Holdings L.L.C. NPAR LLC Chevron USA, Inc. Chesapeake Appalachia L.L.C. SWN Production Company L.L.C.	18.75%	701/488 24/180 756/332 30/532 33/110
8)	12-1-18.3	Violet S. Miller	7.99	733674-000	Violet S. Miller	Tri Energy Holdings L.L.C. NPAR LLC Chevron USA, Inc. Chesapeake Appalachia L.L.C. SWN Production Company L.L.C.	16.00%	699/11 24/180 756/332 30/532 33/110
9)	12-1-14	Kenneth L. McNinch	39.04	726801-001	Kenneth L. McNinch	Chesapeake Appalachia L.L.C. SWN Production Company L.L.C.	16.00%	697/61 33/110
10)	12-1-12	Pete E. and Susan K. Malarski	25.377	733648-000	Pete E. and Susan K. Malarski	Tri Energy Holdings L.L.C. NPAR LLC Chevron USA, Inc. Chesapeake Appalachia L.L.C. SWN Production Company L.L.C.	18.00%	695/268 24/180 756/332 30/532 33/110
11)	12-1-13	Michael L. and Tylene R. Coffield	71.58	726891-000	Michael L. and Tylene R. Coffield	Chesapeake Appalachia L.L.C.	18.75%	700/211

047-051-01982 MOD

RECEIVED  
Office of Oil and Gas  
MAR 8 2018  
WV Department of  
Environmental Protection

Attached to and made a part of the State of West Virginia Oil and Gas Permit Form, WW-6A1, by SWN Production Company, LLC., Operator  
 EXHIBIT "A"  
 BW Edge MSH 205H  
 Marshall and Ohio Counties, West Virginia

12)	12-1-10.1	Walter Lewis Hartman and Gloria Louise Hartman	47.81	725884-000	Walter Lewis Hartman and Gloria Louise Hartman	SWN Production Company L.L.C.	33/110	
						Chesapeake Appalachia L.L.C.	14.00%	688/622
						SWN Production Company L.L.C.		33/110
13)	06-T17-009-3	Gregory W. and Jill Ann Beall	20.00	726593-000	Gregory W. and Jill Ann Beall	Chesapeake Appalachia L.L.C.	12.50%	800/5
						SWN Production Company L.L.C.		33/110
14)	06-T17-009-1	Gregory W. and Jill Ann Beall	17.60	726593-000	Gregory W. and Jill Ann Beall	Chesapeake Appalachia L.L.C.	12.50%	800/5
						SWN Production Company L.L.C.		33/110

RECEIVED  
 Office of Oil and Gas

JAN 31 2018

WV Department of  
 Environmental Protection

047-051-01982 MOD

RECEIVED  
 Office of Oil and Gas

MAR 8 2018

WV Department of  
 Environmental Protection



SWN Production Company, LLC  
P O Box 12359  
Spring, Texas 77391-2359  
www.swn.com

October 12, 2017

Ms. Laura Adkins  
WV DEP Office of Oil & Gas  
601 57<sup>th</sup> St., SE  
Charleston, WV 25304

RE: SWN's proposed new Well: B W Edge MSH 5H & B W Edge MSH 205H in Marshall County, West Virginia, Drilling under Walnut Grove Road.

Dear Ms. Adkins:

SWN Production Company, LLC ("SWN") is applying for a drilling permit for the above referenced well. The State of West Virginia has raised some concern as to SWN's right to drill under Walnut Grove Road. Please be advised that SWN has leased all mineral owners under said route as it relates to the above-referenced well and unit.

Thank you.

Sincerely,

Tanner Quiring  
Staff Landman  
SWN Production Company, LLC  
PO Box 1300  
Jane Lew, WV 26378

RECEIVED  
Office of Oil and Gas

OCT 16 2017

WV Department of  
Environmental Protection

RECEIVED  
Office of Oil and Gas

MAR 8 2018

WV Department of  
Environmental Protection



SHL Latitude: N 40°02'30" 697'

BHL Latitude: N 40°02'30"

3048'

4287'

BHL Longitude: W 80°37'30"

12,777'

SHL Longitude: W 80°37'30"

# RETTEW

RETTEW Associates, Inc.  
27 Travata Street, Suite 101  
Bridgeport, WV 26330  
Phone (800) 738-8395  
Email: rettew@rettew.com  
Website: www.rettew.com

LINE	DESCRIPTION	DISTANCE	DESCRIPTION	MONUMENT
L1	N00°41'32"E	195'	SHL TO REF. PIN	IRON PIN
L2	S81°57'39"W	207'	SHL TO REF. PIN	IRON PIN
L3	N43°24'09"W	193'	SHL TO LANDMARK	POST
L4	N03°41'47"E	1,639'	SHL TO LANDMARK	REBAR
L5	N42°32'13"E	1,486'	SHL TO LP	
L6	N24°41'10"W	8,129'	LP TO BHL	

**SURFACE HOLE LOCATION (SHL):**

UTM (NAD83, ZONE 17, METERS):  
NORTHING: 4,428,553.763  
EASTING: 531,795.439

**"LANDING POINT" LOCATION (LPL):**

UTM (NAD83, ZONE 17, METERS):  
NORTHING: 4,428,775.910  
EASTING: 532,153.109

**BOTTOM HOLE LOCATION (BHL):**

UTM (NAD83, ZONE 17, METERS):  
NORTHING: 4,431,138.712  
EASTING: 531,067.035

GRID NORTH  
UTM, NAD83 DATUM, ZONE 17, US FT

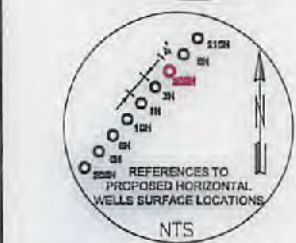
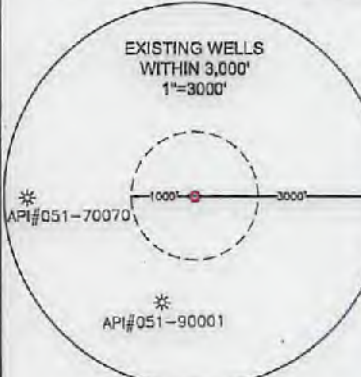
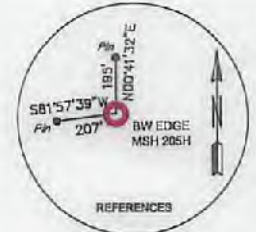

**NOTES ON SURVEY**

- COORDINATES SYSTEM IS UTM, NAD 83 DATUM, ZONE 17, U.S. FOOT AND WELL COORDINATES ESTABLISHED USING SURVEY GRADE GPS.
- SURFACE AND ROYALTY OWNER INFORMATION AND THEIR BOUNDARIES SHOWN HEREON WERE PLOTTED FROM DEEDS AND/OR TAX PARCEL MAPS PROVIDED BY CLIENT AND FIELD LOCATIONS.
- THIS PLAT DOES NOT REPRESENT A BOUNDARY SURVEY OF THE PARCELS SHOWN HEREON.
- NO DWELLINGS AND BUILDINGS WITHIN 625 FEET OF PROPOSED OF CENTER OF PAD.
- NO WATER WELLS OR DEVELOPED SPRINGS WITHIN 250 FEET OF PROPOSED WELL.
- NO PERENNIAL STREAMS, LAKES, PONDS, RESERVOIRS OR WETLANDS WITHIN 100 FEET OF THE LIMITS OF DISTURBANCE.
- NO NATURALLY PRODUCING TROUT STREAM WITHIN 300 FEET OF LIMITS OF DISTURBANCE.

I, THE UNDERSIGNED, HEREBY CERTIFY THAT THIS PLAT IS CORRECT TO THE BEST OF MY KNOWLEDGE AND BELIEF AND SHOWS ALL THE INFORMATION REQUIRED BY LAW AND REGULATIONS ISSUED AND PRESCRIBED BY THE DEPARTMENT OF ENVIRONMENTAL PROTECTION.

P.S. 2241 *Craig Robert West*

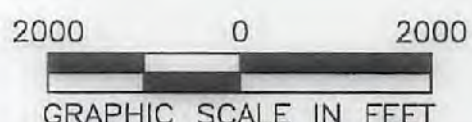
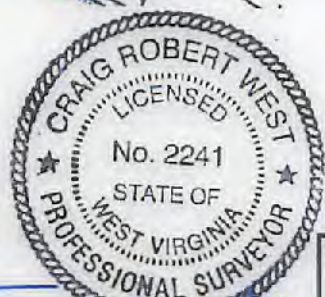

(+) DENOTES LOCATION OF WELL ON UNITED STATES TOPOGRAPHIC MAPS  
WVDEP  
OFFICE OF OIL & GAS  
601 57TH STREET  
CHARLESTON, WV 25034

MINIMUM DEGREE OF ACCURACY: 1/200  
PROVEN SURVEY SOURCE OF GRADE GPS ELEVATION: (NAVD 88, US FT)

COMPANY:	<b>SWN</b> Production Company, LLC		
OPERATOR'S WELL #:	BW EDGE MSH 205H		
API WELL #:	47	051	01843
	STATE	COUNTY	PERMIT

WELL TYPE: OIL  WASTE DISPOSAL  PRODUCTION  DEEP  GAS  LIQUID INJECTION  STORAGE  SHALLOW

WATERSHED: UPPER OHIO SOUTH ELEVATION: 1,254.0' AS-BUILT

DISTRICT: SAND HILL COUNTY: MARSHALL QUADRANGLE: WHEELING, W.VA-OHIO

SURFACE OWNER: EDGE, WILLIAM F. JR. & BARBARA ACREAGE: 87.8±

OIL & GAS ROYALTY OWNER: FLETCHER, JOSEPHINE ACREAGE: 115.8±

DRILL  DRILL DEEPER  REDRILL  FRACTURE OR STIMULATE  PLUG OFF OLD FORMATION  PERFORATE NEW FORMATION

CONVERT  PLUG & ABANDON  CLEAN OUT & REPLUG  OTHER CHANGE  (SPECIFY)

TARGET FORMATION: MARCELLUS ESTIMATED DEPTH: 6,377' TVD 15,528' TMD

WELL OPERATOR: SWN PRODUCTION COMPANY, LLC DESIGNATED AGENT: DEE SOUTHALL  
ADDRESS: P.O. BOX 1300 ADDRESS: P.O. BOX 1300  
CITY: JANE LEW STATE: WV ZIP CODE: 26378 CITY: JANE LEW STATE: WV ZIP CODE: 26378

<b>LEGEND:</b>	<b>REVISIONS:</b>	<b>DATE:</b> 04-10-2017
● PROPOSED SURFACE HOLE / BOTTOM HOLE		
⊙ EXISTING / PRODUCING WELLHEAD		
⊘ ABANDONED WELL	--- LEASE BOUNDARY	DRAWN BY: J. SCHOLL
⊙ PLUGGED & ABANDONED WELL	--- MARCELLUS DOWN HOLE PATH	SCALE: 1" = 2000'
△ CUT CONDUCTOR	--- ABANDONED PATH	DRAWING NO: 087569005
		WELL LOCATION PLAT





RETTEW Associates, Inc.  
27 Travato Street, Suite 101  
Bridgeport, WV 26330  
Phone (800) 738-8395  
Email: rettetw@rettetw.com  
Website: www.rettetw.com

TRACT	ADJOINING PARCELS	TAX PARCEL	ACRES
A	FOLMER, EDITH ADELL	12-1-19	122.623±
B	ADASE, GEORGE & LAURIE	12-1-28	33.752±
C	ADASE, GEORGE & LAURIE	12-1-29	37.599±
D	LEASURE, ANNA	12-1-30	20.00±
E	BARTLOVICH, STEPHEN M.	12-1-18.4	10.0±
F	BARTLOVICH, STEPHEN M.	12-1-11	48.85±
G	COFFIELD, MICHAEL L. & TYLENE R.	12-1-10	186.693±
H	HAMILTON, MARY SCHENK & GARY P.	12-1-5.1	86.65±
I	SNYDER, LONNIE, A.	12-1A-83	0.6536±
J	SNYDER, LONNIE, A.	12-1A-83.2	0.5951±
K	STALEY, DAVID A. ET UX	12-1A-77	0.895±
L	YOUNG, ALBERT R. SR.	T17-B321	1.00±
M	YOUNG, ALBERT R. SR.	T17-B321	2.3±
N	HARTMAN, WALTER L. & GLORIA L.	T17-17	3.95±
O	HETZEL, JERALD L. & KIMBERLY E.	T17-17.10	0.8±
P	HOLMES, DANIEL P. & LAURA S.	T17-17.2	0.30±
Q	COMSTOCK, YUKIKO	T17-17.3	0.30±
R	HARTMAN, WALTER L. & GLORIA L.	T17-17.11	0.90±
S	CAPPONE, RAYMOND A. & KAREN	T17-15	18.62±
T	OWNER NAME	DEED #	0.000
U	BEALL, THOMAS E. & J R	T17-17.92	0.43±
V	BEALL, GREGORY W. & J A	T17-17.9	3.05±
W	RIDGE RUNNER FARM LLC	T12-14	95.85±
X	OWNER NAME	DEED #	0.000
Y	DAVIS, ROBERT H. & M J	T17-13	25.68±
Z	LENZ, PATRICK J.	12-1-46	63.22±
AA	LENZ, PATRICK J.	12-1-14.1	15.744±
BB	LITMAN, JAMES L. ET UX	12-1-14.2	12.69±
CC	LITMAN, JAMES L. ET UX	12-2-1	91.841±
DD	LITMAN, JAMES L. ET UX	12-2-16.4	11.82±
EE	EDGE, WILLIAM F. JR. ET AL	12-2-16.5	6.00±
FF	EDGE, WILLIAM F. JR. ET AL	12-2-16	22.25±
GG	GIZA, CHESTER A. ET UX	12-1-16.1	2.22±
HH	GIZA, CHESTER A. ET UX	12-1-16.2	2.009±
II	EDGE, WILLIAM F. JR. ET AL	12-2-15	17.28±
JJ	GIZA, CHESTER A. ET UX	12-2-14	59.15±
KK	ISLAY, ROBERT A. SR. ESTATE	12-2-13	12.01±
LL	GIBSON, WILLIAM E.	12-9-12	31.11±
MM	ISLAY, ROBERT A. SR. ESTATE	12-9-9	58.50±
NN	NORMAN, JOSEPHINE GRACE	12-1-18.1	0.35±
OO	STRICKLIN, ARTHUR W. ET UX LIFE ESTATE	12-1-15.1	0.37±
PP	STRICKLIN, ARTHUR W. ET UX LIFE ESTATE	12-1-15.2	1.58±

REVISIONS:

COMPANY:

**SWN**  
Production Company, LLC

**SWN** <sup>R-A-V+</sup>  
Production Company™

OPERATOR'S BW EDGE MSH  
WELL #: 205H

DATE: 04-10-2017

LOCATION: SAND HILL DISTRICT,  
MARSHALL COUNTY, WEST VIRGINIA

DRAWN BY: J. SCHOLL  
SCALE: N/A  
DRAWING NO: 087569005  
ADJOINING OWNERS